

# BRITANNIA

## DECK PLANS



### BRITANNIA

141,000 tons

Normal operating capacity:

3,647 passengers and 1,350 crew

#### Suite with Bath/Shower

<b>B1</b>	<b>B2</b> B Deck
<b>B4</b>	B, C, D, E & F Deck
<b>B5</b>	A, C, D, E, F & G Deck

#### Superior Deluxe Balcony with Bath/Shower

<b>DA</b>	B & C Deck
<b>DB</b>	A, B & C Deck
<b>DC</b>	A Deck

#### Balcony with Shower and Sofa

<b>GA</b>	F Deck
<b>GB</b>	C, D, E & F Deck
<b>GC</b>	A & G Deck
<b>GD</b>	B, C, D, E & F Deck
<b>GE</b>	A, B, F & G Deck
<b>GF</b>	A & G Deck

#### Balcony with Shower (without Sofa)

<b>HA</b>	B, C, D, E & F Deck
<b>HB</b>	A, B, C, D, E & F Deck
<b>HC</b>	A Deck
<b>HD</b>	B, C, D, E & F Deck
<b>HE</b>	A, B, C, D, E, F & G Deck
<b>HF</b>	A Deck

#### Balcony (Obstructed View) with Shower and Sofa

<b>IB</b>	<b>IC</b>	<b>IE</b> G Deck
-----------	-----------	------------------

#### Balcony (Obstructed View) with Shower (without Sofa)

<b>JB</b>	<b>JC</b>	<b>JE</b> G Deck
-----------	-----------	------------------

#### Larger Inside with Shower

<b>OA</b>	B & C Deck
<b>OB</b>	A, B & C Deck

#### Inside with Shower

<b>PA</b>	B, C, D, E & F Deck
<b>PB</b>	B, C, D, E, F & G Deck
<b>PC</b>	A & G Deck
<b>PD</b>	B, C, D & E Deck
<b>PE</b>	A, B, C, D, E & F Deck
<b>PF</b>	A Deck

#### Single Balcony with Shower

<b>QF</b>	Lido Deck
-----------	-----------

#### Single Inside with Shower

<b>SF</b>	Lido Deck
-----------	-----------



Suite



Superior Deluxe Balcony



Balcony without sofa



Inside



Single Balcony



Single Inside

## SPORTS DECK

## SUN DECK

## LIDO DECK

## CABIN NOTES

- \* Cabin has one additional bed in the form of a single sofa bed
- Cabin has one additional bed in the form of an upper pullman berth
- \*\* Cabin has two additional beds in the form of a double sofa bed
- ✧ Cabin has two additional beds in the form of upper pullman berths
- ≈ Cabin has two additional beds, one in the form of a single sofa bed and one in the form of an upper pullman berth
- # Steel fronted balcony
- ∨ Overlooked by balconies above
- Balcony is partially shaded
- ♿ All adapted cabins have a shower only
- Ω Restricted access to balcony (when at sea)

**Note:** All upper berths in twin cabins are accessible via a ladder. When upper berths are in use lower berths cannot be converted to a double. Restricted access to balcony when upper berth is in use.

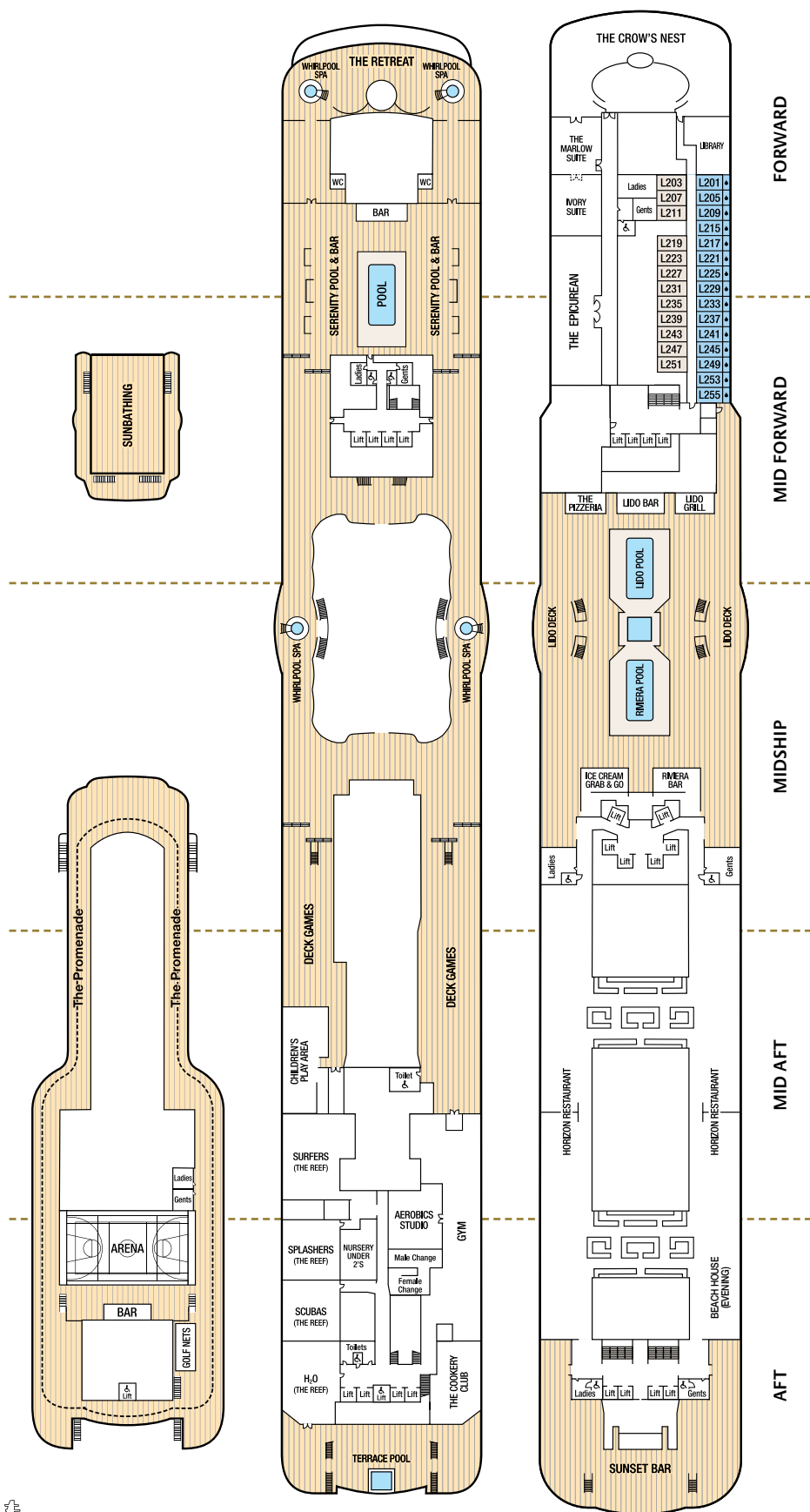
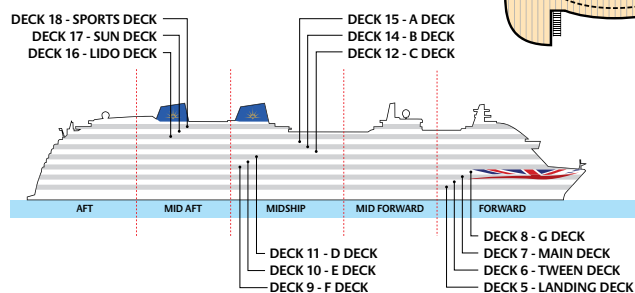

A DECK

B DECK

C DECK

D DECK

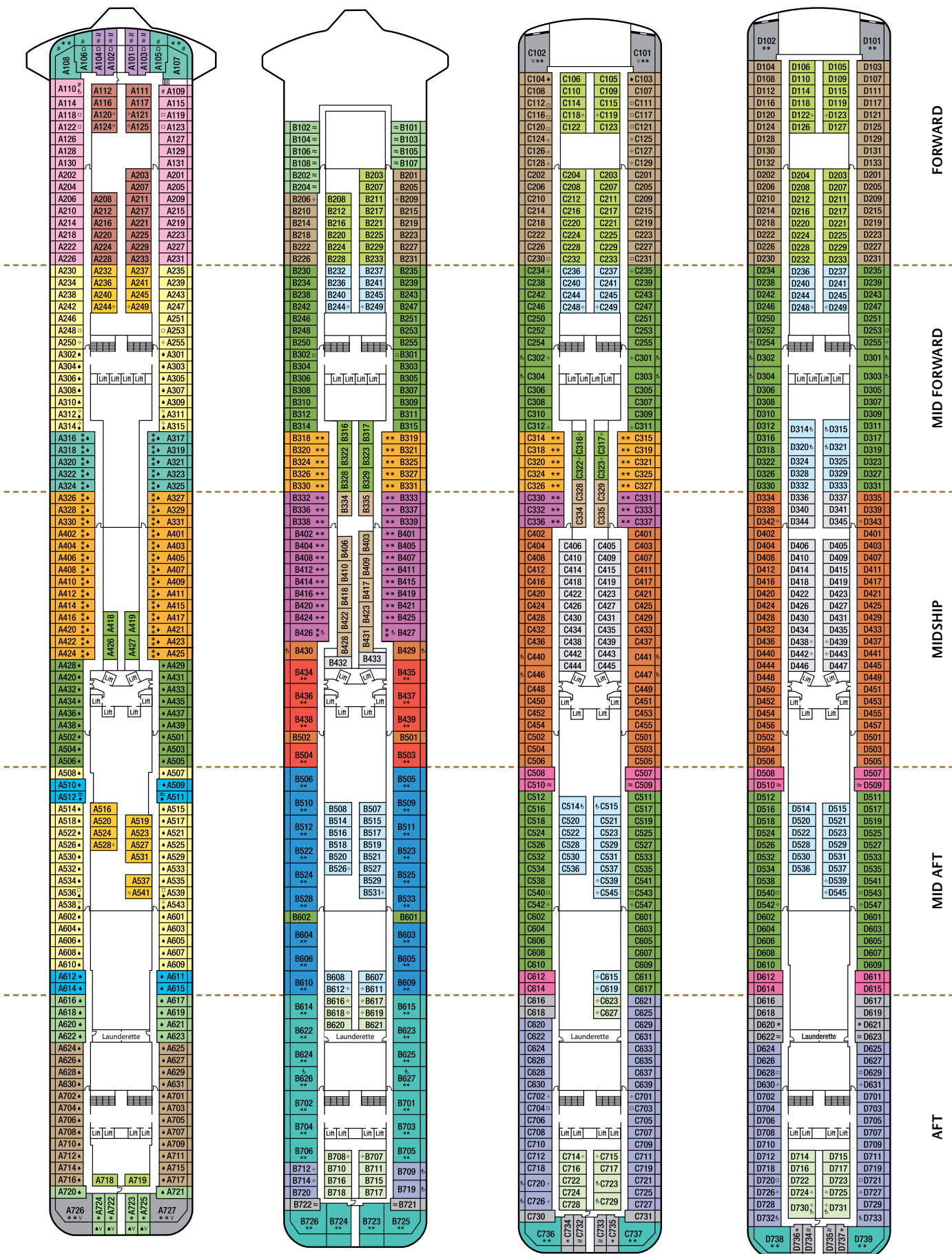

## G DECK

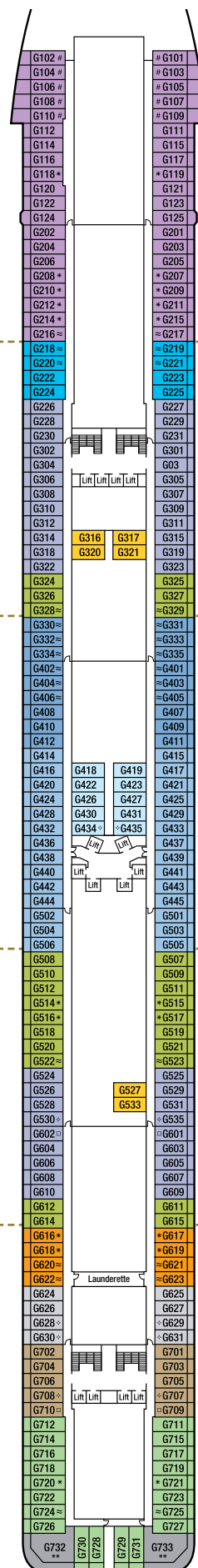

**AFT**

DECK 7

DECK 6

DECK 5

